

*Sunbeam*

## Electric Shaver

Instruction Booklet  
SH3300

Please read these instructions carefully  
and retain for future reference.

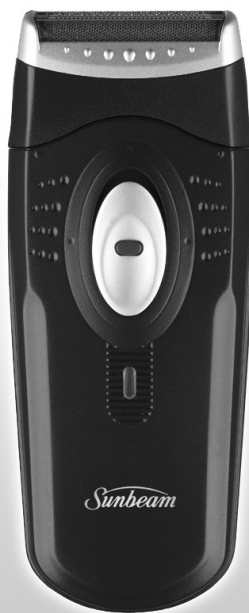

## Contents

Sunbeam's Safety Precautions	1
Features of your Rechargeable Shaver	2
Using your Rechargeable Shaver	4
Care and Cleaning of your Rechargeable Shaver	5
Battery Disposal	6
Registration Form	7

تحتوي هذه الوثيقة على معلومات هامة تتعلق بالسلامة.

請務必閱讀此項安全指示與詳

說明書，以瞭解此剃鬚刀之安全使用及各項功能。

Verzamen Sie de volgende beschrijvende  
instructies aandachtig aandachtig.

Внимательно прочтите прилагаемые инструкции  
использования.

Pažinkite patalpinimą instrukcijoms ir naudokite saugiai  
ir atsargiai.

Assolutamente leggere attentamente le istruzioni sono  
compilate a dovere.

この取扱説明書には重要な安全に関する情報が含まれています。

Yeni bir elektrikli alet kullanmadan önce mutlaka bu  
kullanım talimatlarını okuyunuz.

Regulez ce que les précautions de sécurité  
indiquées sont bien comprises.

تأكد من أن التعليمات المتعلقة بالسلامة  
مفهومة جيداً.

Обязательно прочтите прилагаемые инструкции  
по использованию.

Yusatica be tihon dovolik de kanka re, antes de gram  
emir el, fue.

Крайне внимательно прочтите инструкцию  
использования.

## Sunbeam's Safety Precautions

### SAFETY PRECAUTIONS FOR YOUR RECHARGEABLE SHAVER.

- Never touch the power plug with wet hands when unplugging it or plugging it in.
- Use only the cord supplied with this appliance.
- Always keep the shaver and power plug out of reach of children.
- Do not expose the shaver to temperatures below -10°C or above +40°C for prolonged periods of time.
- Do not use the shaver with a broken or damaged foil or cutter blocks.
- If the appliance is used with an extension cord or electrical portable outlet device they should be positioned so they are not subject to splashing or moisture.
- This appliance must not come into contact with water or any other liquid. Please see the section on Cleaning for instructions on how to keep your shaver clean.
- Empty or broken rechargeable batteries MUST NOT be disposed of as household waste. Please see the section on Battery Disposal for instructions.

**Sunbeam are very safety conscious when designing and manufacturing consumer products, but it is essential that the product user also exercise care when using an electrical appliance. Listed below are precautions which are essential for the safe use of an electrical appliance:**

- Read carefully and save all the instructions provided with an appliance.
- Always turn the power off at the power outlet before you insert or remove a plug. Remove by grasping the plug - do not pull on the cord.
- Turn the power off and remove the plug when the appliance is not in use and before cleaning.
- Do not use your appliance with an extension cord unless this cord has been checked and tested by a qualified technician or service person.
- Always use your appliance from a power outlet of the voltage (A.C. only) marked on the appliance.
- Close supervision is necessary when your appliance is being used near children or infirm persons.
- Never leave an appliance unattended while in use.
- Young children should be supervised to ensure that they do not play with the appliance.
- Do not use an appliance for any purpose other than its intended use.
- Do not place an appliance on or near a hot gas flame, electric element or on a heated oven. Do not place on top of any other appliance.
- Do not let the power cord of an appliance hang over the edge of a table or bench top or touch any hot surface.
- For safety reasons and to avoid maintenance by unskilled persons, some appliances are 'sealed' using tamperproof screws. Such appliances should always be returned to the nearest Sunbeam Appointed Service Centre for adjustment or repair if required.
- Do not operate any electrical appliance with a damaged cord or after the appliance has been dropped or damaged in any manner. If damage is suspected, return the appliance to the nearest Sunbeam Appointed Service Centre for examination, repair or adjustment.
- For additional protection, Sunbeam recommend the use of a residual current device (RCD) with a tripping current not exceeding 30mA in the electrical circuit supplying power to your appliances.
- Do not immerse the appliance in water or any other liquid unless recommended.

If you have any concerns regarding the performance and use of your appliance, please visit [www.sunbeam.com.au](http://www.sunbeam.com.au) or contact the Sunbeam Consumer Service Line. Ensure the above safety precautions are understood.

## Features of your Rechargeable Shaver

**Protective cap**

**Shaver head**

**Shaving foil**

**Integrated long hair trimmer**

**Cutter blocks**

**On/off switch**

**Travel lock**

**Charge indicator**

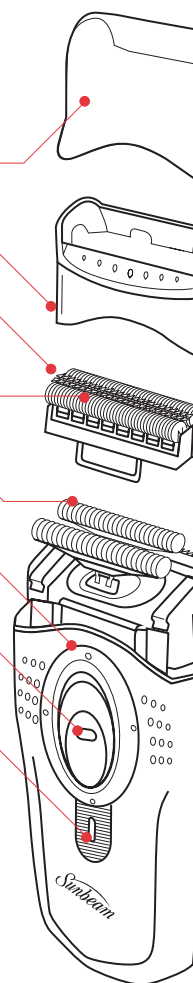

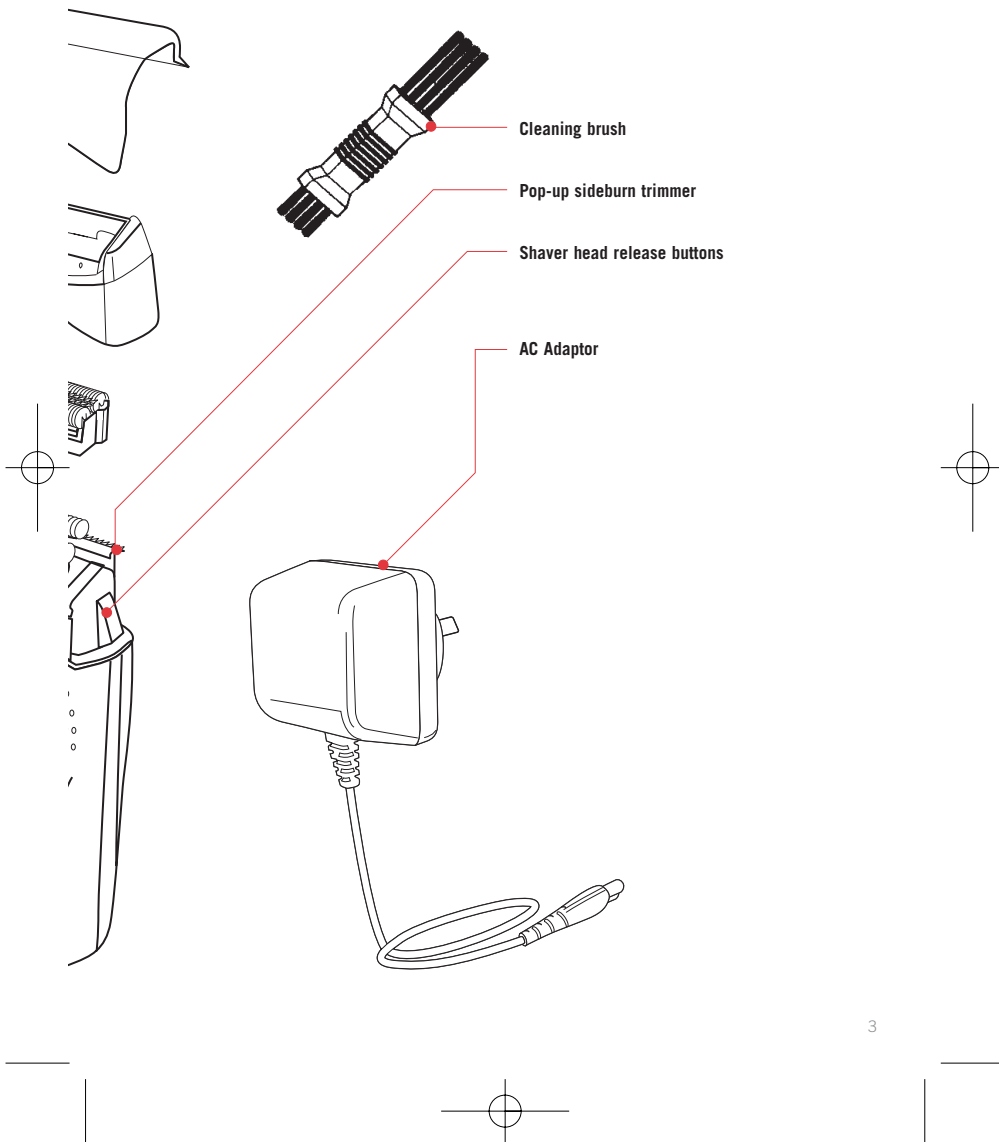

## Using your Rechargeable Shaver

### Charging

- This shaver must be charged in order to operate. It cannot operate from the mains.
- To reach optimum recharge capacity, the batteries should be charged for 8 hours before the shaver is used for the first time.
- The appliance is protected against over charging but continuous charging is to be avoided.
- A full charge will give you up to 45 minutes cordless shaving time.
- Use the shaver normally until the batteries are completely discharged before fully charging them again.
- To maintain optimum charge capacity, this charging and discharging procedure should be repeated several times per year.
- While the shaver is charging the LED will be illuminated.

### Using your Shaver

- Ensure that the shaver is charged and the cord is removed.
- For best results use the shaver on clean, dry skin.
- Hold the shaver at a right angle to your skin. Apply light pressure only.
- Stretch your skin with your free hand so that the hairs stand upright.
- Shave against the direction of growth of hair to achieve the best results.
- After shaving put the protective cap back on the shaver head.
- Avoid pressure on the foil as this may cause damage.

**Note:** Allow the shaver to completely discharge before charging the batteries again.

### Using the Pop-up sideburn trimmer

The integrated side burn trimmer can be used to shorten longer beard stubble in order to have a more effective shave as well as to trim sideburns. Extend the trimmer by sliding it upwards until it clicks into position and retract by pushing down.

**If you are using a foil shaver for the first time, it may take around three to four weeks for your skin to get used to this new method of shaving**

## Care and Cleaning

- Do not immerse the shaver in water or any other liquid.
- Press the two shaver head release buttons and pull the shaver head from the casing
- Tap the shaver head on a flat surface or blow the hairs out thoroughly (fig. 1).
- Clean the cutter blocks using the cleaning brush supplied.
- Never use the brush on the foil as this may damage it.

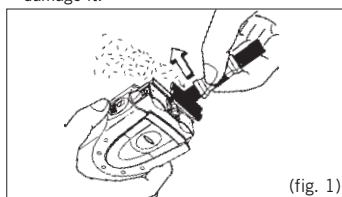

### Changing the foil and cutter blocks

Shaving performance depends on the condition of the foil and the cutter blocks. Both wear gradually in use. Therefore it is recommended that the shaving foil be changed once a year and the cutter blocks changed every two years.

### Replacing the shaving foil

- Remove the shaver head by pressing the two release buttons.
- Pull the shaving foil out of the shaver head by holding it on the attached straps (fig. 2).
- Place the new shaving foil in the shaver head until it clicks in position.
- Replace the shaver head.

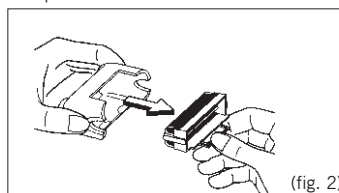

### Replacing the cutter blocks

- Remove the shaver head
- Hold the cutter blocks on both sides and lift them from their supports (fig. 3).
- Place the new cutter blocks in position.
- Replace the shaver head.

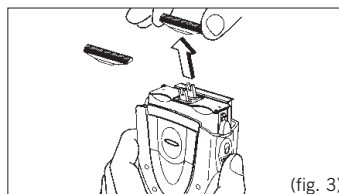

## Battery Disposal

The battery must not be disposed of in ordinary household waste. At the end of the shaver's life, the shaver must be returned to a Sunbeam Service Centre for correct disposal of the rechargeable battery.

The battery must be removed from the appliance before it is scrapped.  
The battery is to be disposed of safely.

---

## 2 Year Replacement Guarantee

We are so confident of the quality of our product, should this appliance develop any malfunction within 2 years of purchase (3 Months commercial use) due to faulty materials or manufacture, we will replace it for you absolutely free. **Foils and cutter blocks are excluded from this guarantee.**

---

## Help Line

If you have any additional questions about using your Sunbeam Rechargeable Shaver, please call the Sunbeam help line in Australia on 1 800 025 059.  
In New Zealand please call 09 912 0747.





## WIN a Sunbeam Air Cleaner valued at \$199.95

Congratulations on the purchase of your new Sunbeam product. We at Sunbeam take the design and development of our products very seriously and are constantly striving to offer you both improved as well as innovative new products. In order to help us to do this, please take a few moments to complete this form. Return it to us within 4 weeks of the date of your purchase and you'll be entered into the next monthly competition. Entries for the final competition close 5pm 31st December 2005. Please complete the survey and tell us in 25 words or less why you like your product or how it could be improved. The best 5 entries each month as determined by the judges, will receive a Sunbeam Air Cleaner valued at \$199.95.

Name: \_\_\_\_\_

Address: \_\_\_\_\_

State: \_\_\_\_\_ Post Code: \_\_\_\_\_

Name of Product: \_\_\_\_\_ Model Number: \_\_\_\_\_  
(shown on the front of the instruction booklet)

Tell us in 25 words or less why you like your Sunbeam product or how it could be improved: \_\_\_\_\_

\_\_\_\_\_

\_\_\_\_\_

I do not wish to receive any further information on new products, special offers or upcoming promotions.

Was your product a gift?  Yes

No

If your product was a gift, did you request it?

Yes

No



If it was a gift, who gave it to you?  Husband/Partner  Wife/Partner  Children  
 Friends  Parents  Relatives

To which age group do you belong?  Under 25  26-35  36-44  45-54  over 55

What other types of products would you like to see in the range? \_\_\_\_\_  
\_\_\_\_\_  
\_\_\_\_\_

If you purchased the product, please indicate why you bought it. (Tick any that apply)

Saw it In-store  Store Demo  Advertisement  Recommendation  
 Other (please specify) \_\_\_\_\_

Where did you last read or hear about Sunbeam's Personal Care range?

Television  Magazines  Newspapers  From a friend or relative  
 From a salesperson  In store material  Other (Please specify) \_\_\_\_\_  
\_\_\_\_\_  
\_\_\_\_\_

**Please return to:** Sunbeam Corporation Ltd, Locked Bag 5040, Botany NSW 1455  
**Or register online at:** [http://www.sunbeam.com.au/service/personal\\_care\\_registration.cfm](http://www.sunbeam.com.au/service/personal_care_registration.cfm)

**Terms and Conditions**

The best 5 entries as determined by the judges in each month's competition will receive a Sunbeam Air Cleaner valued at \$199.95. Upon receipt of completed surveys, Sunbeam will de-identify your answers to the survey questions from your name, address, phone number and e-mail details. Such de-identified survey responses will be used for statistical purposes with Sunbeam. Your personal details will, unless otherwise advised, be entered into a database for future marketing and promotional activities and will be stored at the office of Sunbeam. A request to access, update or correct any information should be directed to [custserv@sunbeam.com.au](mailto:custserv@sunbeam.com.au). Visit [www.sunbeam.com.au](http://www.sunbeam.com.au) to view our privacy policy.

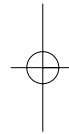
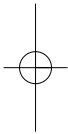

'Sunbeam', is a registered trademark of Sunbeam Corporation.  
Made in Hungary. Due to minor changes in design or otherwise, the product may differ from the one shown in this leaflet. Backed by Sunbeam's 2 Year Replacement Guarantee and National Service Network.

© Copyright. SUNBEAM CORPORATION LIMITED 2004.  
(INCORPORATED IN N.S.W.) A.C.N. 000 006 771

Sunbeam Corporation is a division of GUD Holdings Ltd.

For more information or advice on this or any other Sunbeam appliance, visit [www.sunbeam.com.au](http://www.sunbeam.com.au) or contact the Sunbeam Consumer Service Line.

**Australia 1800 025 059**  
**New Zealand (09) 912 0747.**

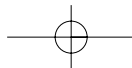

The Sunbeam logo consists of the word "Sunbeam" in a white, elegant script font, set against a solid red rectangular background.

Consumer Hotline

Australia  
1800 025 059

New Zealand  
(09) 912 0747

[www.sunbeam.com.au](http://www.sunbeam.com.au)

The Sunbeam logo consists of the word "Sunbeam" in a white, elegant script font, set against a solid red rectangular background.

is a registered Trademark of Sunbeam  
Corporation Limited. ACN 000 006 771.  
© Sunbeam Corporation Limited 2004.